

INTERMEDIATE
SKILL

Butterfly Blooms Runner

designed by Marsha Evans Moore
featuring *Goodness Gracious* by Laura Heine

SIZE: 18" x 44"

FREE
PROJECT

THIS IS A DIGITAL REPRESENTATION OF THE QUILT TOP, FABRIC MAY VARY.

PLEASE NOTE: BEFORE MAKING YOUR PROJECT, CHECK FOR ANY PATTERN UPDATES AT WINDHAMFABRICS.COM'S FREE PROJECTS SECTION.



Butterfly Blooms Runner

PROJECT DISCLAIMER: Every effort has been made to ensure that all projects are error free. All the information is presented in good faith, however, no warranty can be given nor results guaranteed. Therefore, we assume no responsibility nor damages that may occur when referring to this pattern. When errors are brought to our attention, we make every effort to correct and post a revision as soon as possible. We suggest you check windhamfabrics.com for pattern updates and to test the pattern prior to making the project. Test templates first, before cutting all the pieces. Free projects are not for resale.

CUTTING NOTES: Draw a Large Triangle Template as shown on page 4. Reverse template on strip to conserve fabric. Your border lengths may vary slightly due to on point assembly.

WOF=WIDTH OF FABRIC

KEY	FABRIC	SKU	YD	CUTTING INSTRUCTIONS
A		53911-4 Melon	3/8	(3) 2" x WOF strips; subcut (2) 2" x 41-1/4" borders and (2) 2" x 18" borders. (3) Fussy-cut (3) 3-3/8" squares centered over flowers.
B		53912-7 Pale Pink	1/2	(2) 6-1/2" x WOF strips; subcut (4) Large Triangle templates and (2) 6-1/2" squares. Cut squares in half once to make (4) Small Triangles.
C		53913-6 Lime	5/8	(12) Leaf templates. BINDING: (6) 2-1/4" x WOF strips, sew short ends together.
D		53913-9 White	1/2	(3) 1-3/4" x WOF strips; subcut (12) 1-3/4" x 8-1/2" strips. (1) 2-1/2" x WOF strip; subcut (12) 2-1/2" squares. (4) 1-1/4" x WOF strips; subcut (2) 1-1/4" x 39-3/4" borders, (2) 1-1/4" x 15-1/4" borders and (24) 1-1/4" squares.
E		53915-15 Cotton Candy	1/4	(2) 2-1/2" x WOF strips; subcut 2-1/2" x 4-1/2" rectangles.
F		53917-15 Cotton Candy	1/8	(2) 2-7/8" squares; cut squares in half once diagonally to make (4) triangles.
G		53917-21 Pale Blue	1/8	(1) 2-7/8" x WOF strip; subcut (4) 2-7/8", (4) 2-1/8" and (2) 1-3/4" squares. Cut 2-7/8" and 2-1/8" squares in half once diagonally to make (8) triangles each.
		Backing	1-1/2	Batting: 26" x 52"

ADDITIONAL MATERIALS Template plastic

Optional: For turned edge appliqué: freezer paper or other template paper
For raw edge appliqué: paper backed fusible webbing



Butterfly Blooms Runner

BLOCK ASSEMBLY

1. Prepare (12) **C** Leaf appliqué pieces using your preferred appliqué method. Trace the pattern for Leaf Placement to (12) **D** 2-1/2" squares.
2. Fuse, baste or pin (1) **C** Leaf appliqué diagonally on (1) **D** 2-1/2" square. Sew along the edges of the Leaf to make a leaf unit. Make 4.
3. Draw a diagonal line on the wrong side of (24) **D** 1-1/4" squares.
4. Place (1) **D** 1-1/4" square on upper right corner of (1) **E** 2-1/2" x 4-1/2" rectangle. Sew along the drawn line. Trim seam allowance 1/4" from the drawn line as indicated by the solid line. Press the **D** piece open.
5. Following steps 3-4, sew (1) **D** 1-1/4" square to the upper left corner of the **E** 2-1/2" x 4-1/2" rectangle to complete a petal unit. Make 4.
6. Sew (2) leaf units to ends of (1) Petal unit to make the side unit. Note orientation of leaf units. Make 2.
7. Sew (2) **G** 2-7/8" triangles to opposite sides of (1) **A** 3-3/8" square. Sew **G** 2-7/8" triangles to the remaining sides to make center square. Trim 1/4" past **A** square points to measure 4-1/2" square.
8. Sew (2) petal units to opposite sides of (1) center square to make center unit. Make 1.

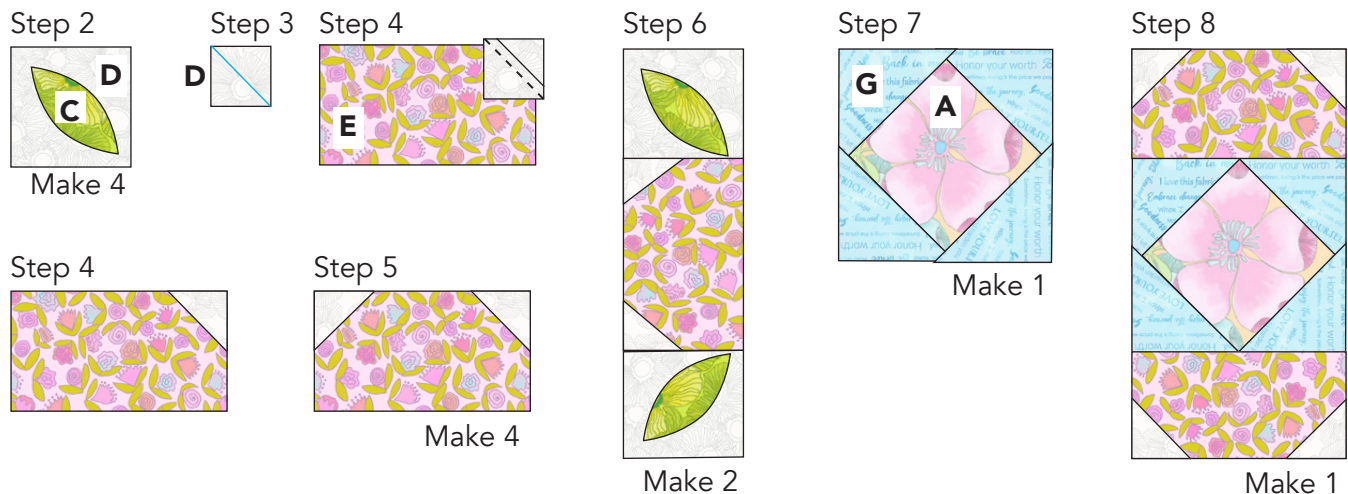



Butterfly Blooms Runner

- Sew (2) side units to opposite sides of the center unit to make (1) flower block. Make 2.
- Following steps 1-9, make (1) flower block using (4) **F** 2-7/8" triangles in step 7. Make 1.

Step 9

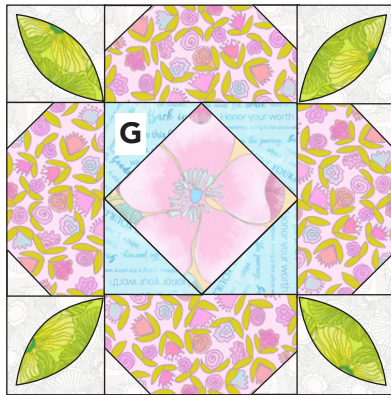

Make 2

Step 10

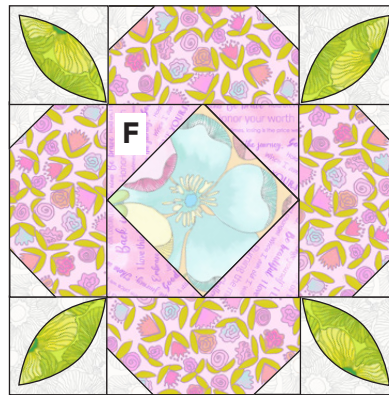

Make 1

Blocks measure
8-1/2" unfinished.

TABLE RUNNER ASSEMBLY

- Following the Table Runner layout on page 4, arrange the flower blocks, Large and Small **B** triangles and **D** 1-3/4" x 8-1/2" strips in diagonal rows. Sew (2) **D** sashing strips to opposite sides of (3) flower blocks.
 - Sew (2) **B** Large triangles to the sides of the sashing strips of the center block. Make 1.
 - Sew (1) **B** Large triangle and (1) **B** Small triangle to the sides of the sashing strips of the end blocks. Make 2.
 - Sew (2) **G** 2-1/8" triangles to ends of (1) **D** 1-3/4" x 8-1/2" strip to make the short sashing strips. Note the orientation of the triangles. Make 1 each.
 - Sew (2) **D** 1-3/4" x 8-1/2" strips to the opposite sides of (1) **G** 1-3/4" square. Sew (2) **G** 2-1/8" triangles to ends to make the long sashing rows. Note the orientation of the triangles. Make 2.
 - Sew together the sashing rows alternating with the block rows, matching the seams, to make the center.
 - Sew (2) **D** 1-1/4" x 39-3/4" borders to sides of center. Sew (2) **D** 1-1/4" x 15-1/4" borders to top and bottom of tablerunner.
 - Sew (2) **A** 2" x 41-1/4" borders to sides of tablerunner. Sew (2) **D** 2" x 18" borders to top and bottom of tablerunner.
- FINISHING:** Layer quilt top, batting and backing together to form quilt sandwich. Baste and quilt as desired. Bind using **C** 2-1/4" strips.



Butterfly Blooms Runner

Table Runner Layout

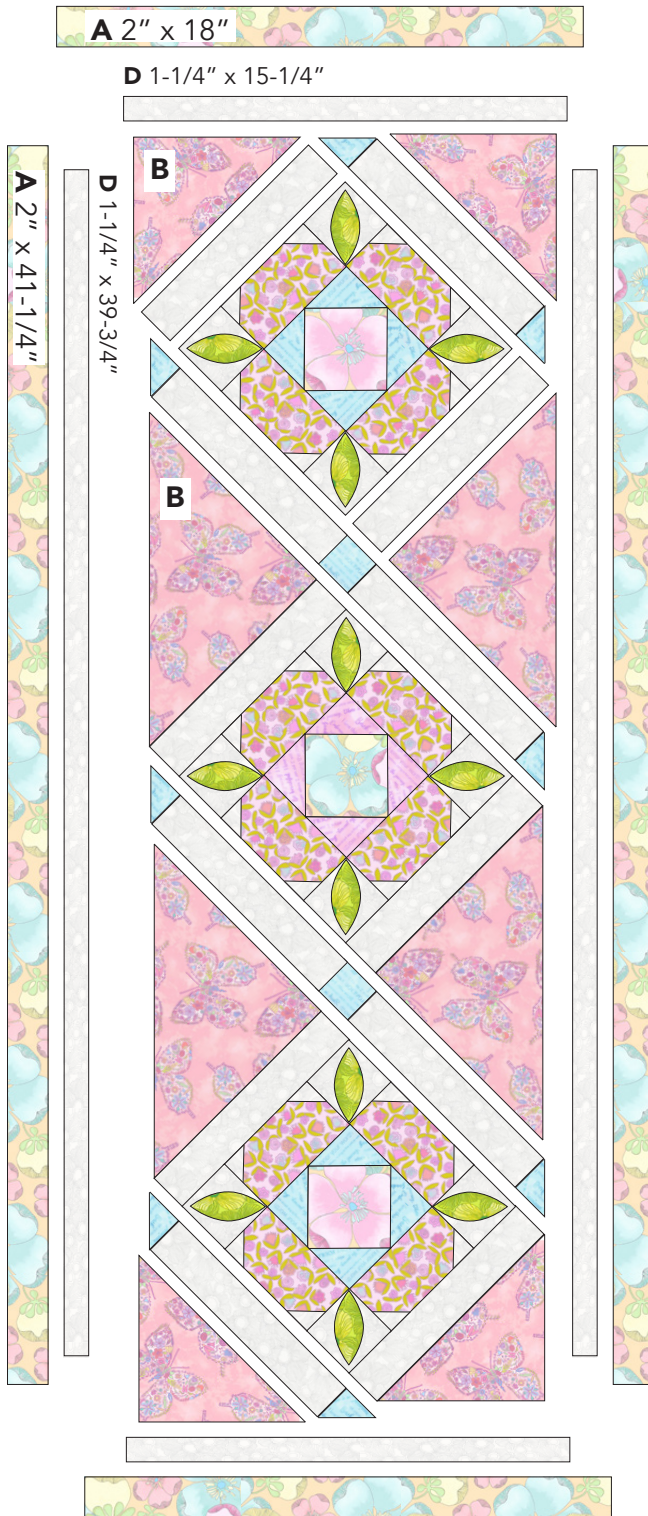

Templates

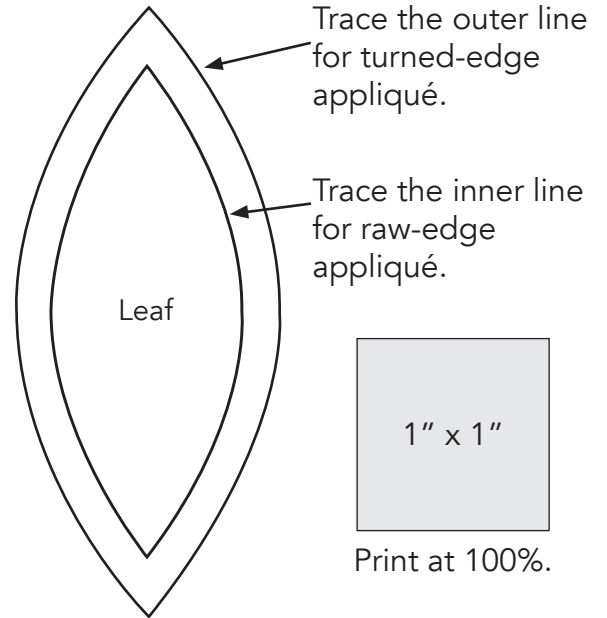

Leaf Placement Pattern

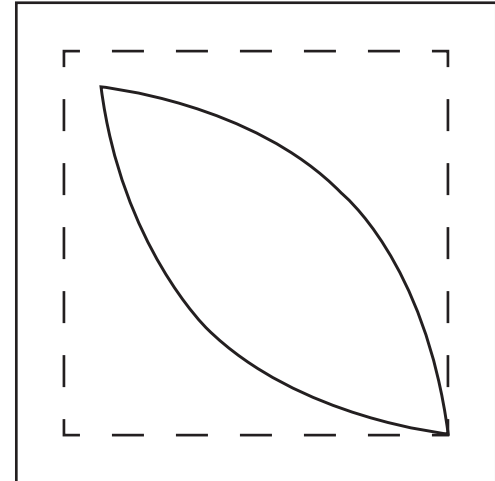

Large Triangle Template

